

# Quadra Small

The Quadra Small cabinet fits in seamlessly with the modular Quadra cabinet range. The width is variable and is determined by the selected version type.

## Frame

- 2 side panels, back, bottom and a plinth on the front.
- The tabletop has straight corners in melaminated chipboard. Thickness: 19 mm.
- The panels are made of melaminated chipboard (thickness: 19 mm).
- The panels are joined together by eccentric cams and dowels.
- The back is milled into a groove in the side panels.
- 4 adjustable synthetic glides.

## Interior finishing depends on the chosen type

- 2 detachable shelves (thickness: 19 mm).

## Doors and drawers depend on the chosen type

- 2 sliding doors on a sound-dampening rail.
- Metal design handle.

## Colours

We would like to refer to our extensive colour gamut.  
Sample card + samples available on request.

(\*) Option

## Dimension

### Model Small:

- height: 76 cm
- length: 84 cm
- depth: 45 cm

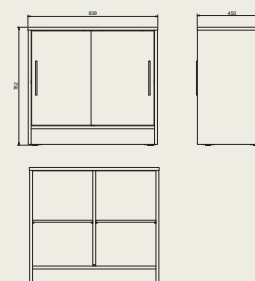

## Materials and finishing

- Wood: - chipboard (melaminated, beech veneer (\*)).
- Withstands the common cleaning products.

For more information about the **materials, construction and maintenance**: please consult our material lists.

## Options

- Finishing in veneer.
- Cylinder lock.
- 4 hidden castors Ø 50 mm.

